

ORDERING INFORMATION

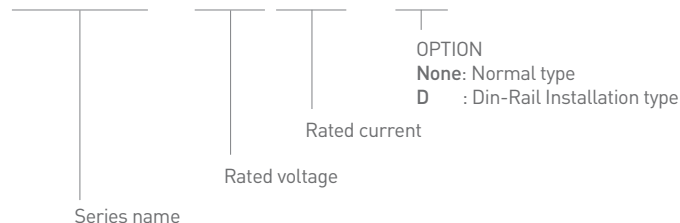

# RMS-2006-□



**FEATURE**

- High attenuation characteristics(150kHz~10MHz)
- Single Phase
- 2-Stage filter
- Low leakage
- Quick and easy push-down terminal block
- Safety cover

**APPLICATION**

- Industrial equipments
- Personal computer & peripherals
- Digital equipments



## RMS SERIES SPECIFICATIONS 1Ø



MODEL	RATED VOLTAGE (AC/DC)	RATED CURRENT	LEAKAGE CURRENT (60Hz)	TEMPERATURE RISE	OPERATING TEMPERATURE RANGE	APPROVAL
RMS-2006	250V Max	6A	1.0mA Max	50°C Max	-25 ~ +85°C	UL, C-UL, CE
RMS-2006-DIN	250V Max	6A	1.0mA Max	50°C Max	-25 ~ +85°C	UL, C-UL, CE
RMS-2010	250V Max	10A	1.0mA Max	50°C Max	-25 ~ +85°C	UL, C-UL, CE
RMS-2010-DIN	250V Max	10A	1.0mA Max	50°C Max	-25 ~ +85°C	UL, C-UL, CE
RMS-2016	250V Max	16A	1.0mA Max	50°C Max	-25 ~ +85°C	UL, C-UL, CE
RMS-2016-DIN	250V Max	16A	1.0mA Max	50°C Max	-25 ~ +85°C	UL, C-UL, CE
RMS-2020	250V Max	20A	1.0mA Max	50°C Max	-25 ~ +85°C	UL, C-UL, CE
RMS-2020-DIN	250V Max	20A	1.0mA Max	50°C Max	-25 ~ +85°C	UL, C-UL, CE
RMS-2030	250V Max	30A	1.0mA Max	50°C Max	-25 ~ +85°C	UL, C-UL, CE
RMS-2030-DIN	250V Max	30A	1.0mA Max	50°C Max	-25 ~ +85°C	UL, C-UL, CE

## RMS SERIES STATIC ATTENUATION CHARACTERISTICS

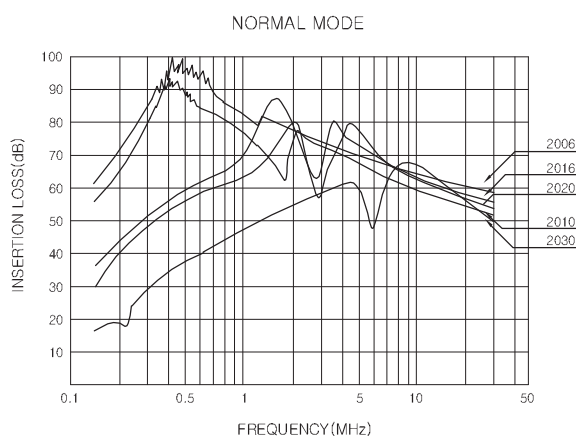
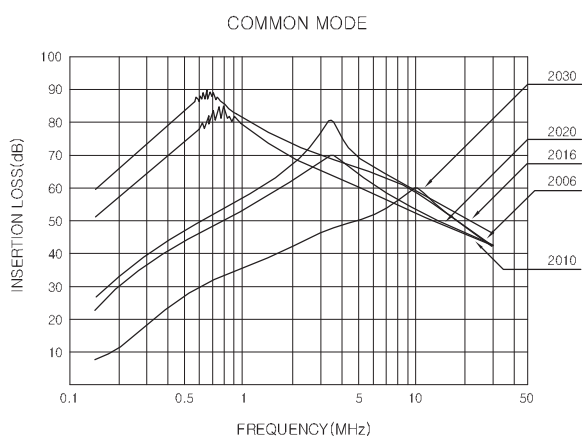

# Dimension

# RMS-2Series

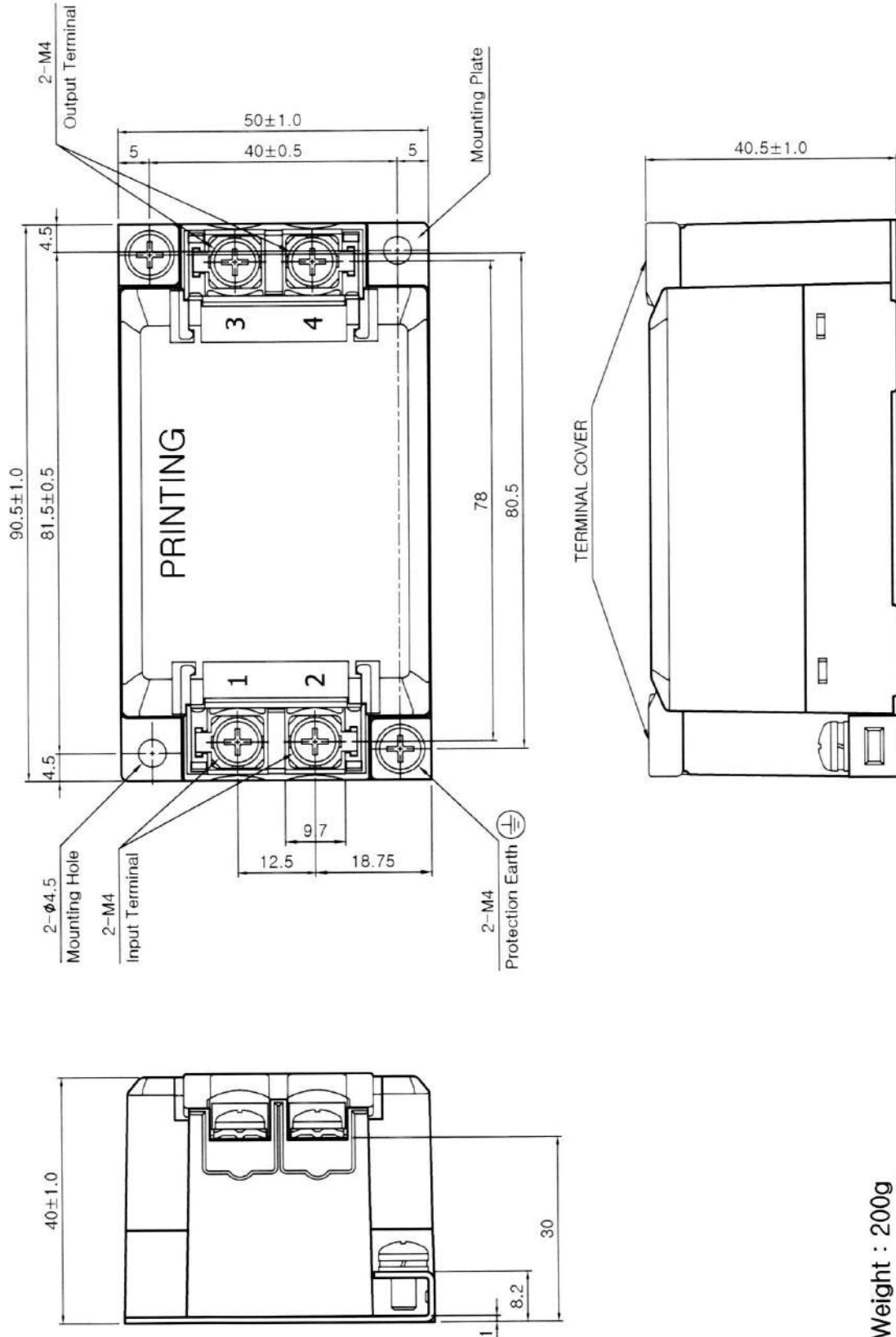

- \* Weight : 200g
- \* Tolerance :  $\pm 1$
- \* Dimensions in mm

# Dimension

# RMS-2S-DIN

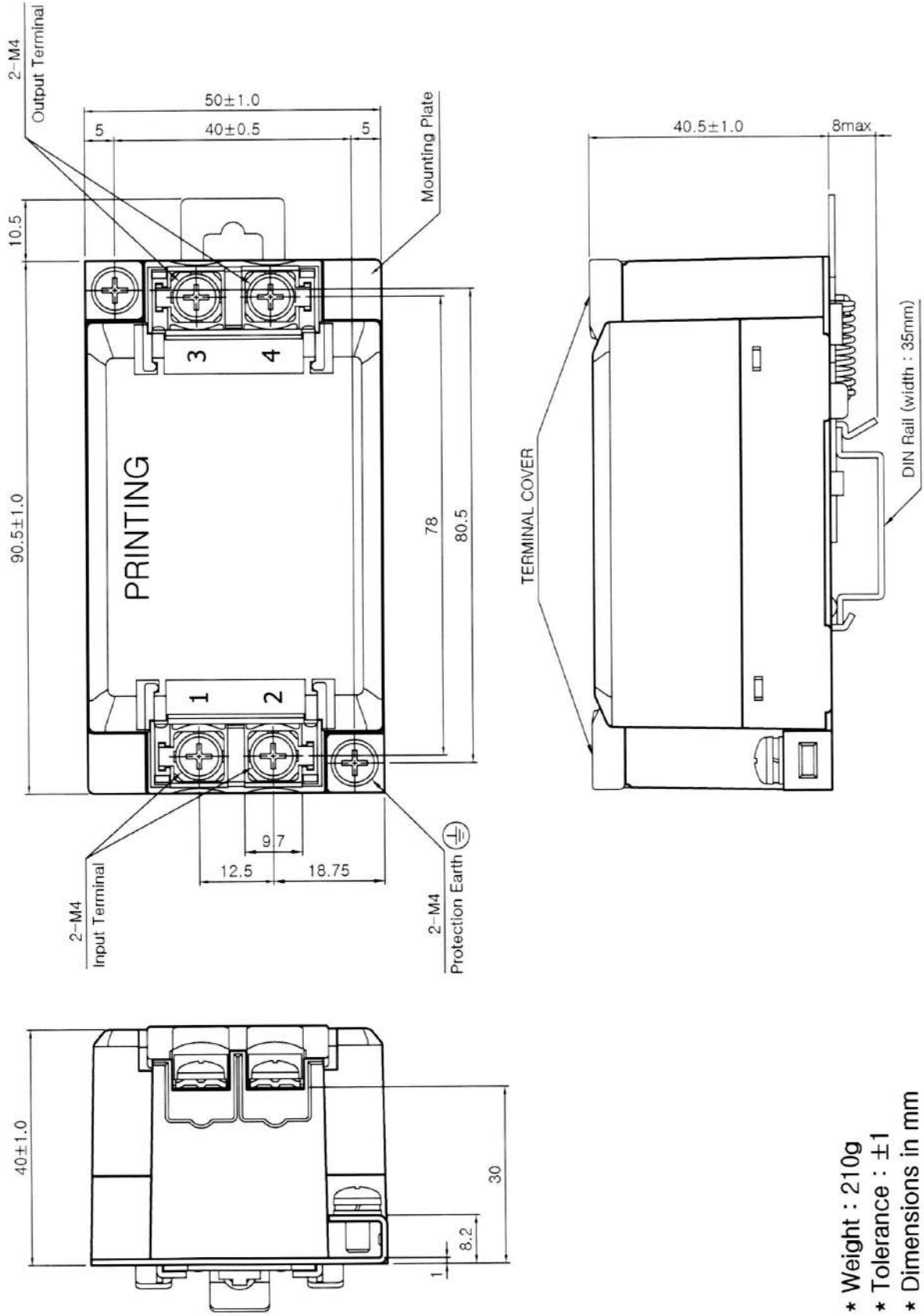

- \* Weight : 210g
- \* Tolerance :  $\pm 1$
- \* Dimensions in mm